

# Fontanilla

## Installation and Instruction Manual



FONTANILLA

**JS Humidifiers plc**

Artex Avenue, Rustington

LITTLEHAMPTON

West Sussex BN16 3LN

United Kingdom

Telephone: 01903 850200

International code +44 1903 850200

FAX: 01903 850 345

International Code +44 1903 850 345

email: [js@humidifiers.co.uk](mailto:js@humidifiers.co.uk)

web: [www.jshumidifiers.com](http://www.jshumidifiers.com)



INVESTOR IN PEOPLE





# Product title

## Introduction

### SAFETY

---

**GENERAL** This manual contains all details for the installation and instructions for use of the Fontanilla

The manual is intended for use by Engineers and properly trained technical personnel. Any work must only be carried out by suitably skilled and qualified personnel, the customer or end-user **MUST** be responsible for ensuring their suitability.

Any risks or hazards, especially when working from ladders or towers, should be identified by a skilled and competent Health & Safety representative and effective control measures put in place.

No liability will attach to JS Humidifiers plc if any damage, injury or accident is attributable to inattentive, inappropriate, negligent or incorrect operation of the machinery whether or not caused deliberately.

Always isolate all electrical and water supplies before commencing any maintenance. Please contact JS Humidifiers plc if in any doubt.

#### HEALTH AND SAFETY



Lifting or handling must only be carried out by trained and qualified personnel. Ensure that the lifting operation has been properly planned, risk assessed and that all equipment has been checked by a skilled and competent Health & Safety representative and effective control measures put in place.

It is the customer's responsibility to ensure that operators are trained in handling heavy goods and to enforce the relevant lifting regulations.

Any personnel handling or lifting the Fontanilla must follow the Lifting Operations and Lifting Equipment Regulations 1998 and Approved Code of Practice L113. The regulation imposes duties on employers and self employed persons and persons who have control, to any extent of lifting equipment.

#### **All installation work must comply with local regulations**

**NOTE** All work concerned with the installation of the water cooler **MUST** only be performed by skilled and qualified technical personnel (e.g. Fitters, electricians, plumbers or technicians with appropriate training). The customer **MUST** be responsible for ensuring their suitability.

All installation work must comply with local regulations.

For the installation of the Fontanilla and associated components there should be no special tooling requirements above that of a fitters toolkit.



# Fontanilla

## Introduction

### Declaration of Conformity

---

**Directives Applied**

Electromagnetic Compatibility Directive 89/336/EEC  
Machinery Directive 98/37/EC Amending Directive 89/392/EEC  
Low Voltage Directive 73/23/EEC

**Standard(s) to which  
Conformity is declared**

EN50081-1:1992, EN50082-1:1992  
EN60204-1:1993, EN292 Parts 1 & 2:1991  
EN349:1993

**Manufacturer's Name  
And Address**

**Authorised Representative  
Address**

JS Humidifiers plc  
Artex Avenue,  
Rustington,  
LITTLEHAMPTON, WEST SUSSEX, UK  
BN16 3LN  
Tel: 01903 850200

**Type of Equipment**

Water Filter

**Model Name(s) & Series(s)**

Fontanilla

**Year of Manufacture**



# Product title

## Contents

---

### Contents:

(i)	Safety
(ii)	Declaration of Conformity
(iii)	Contents
Page 1	Specification
Page 2	Introduction
Page 3	Handling
Page 4	Component identification
Page 5	Installation
Page 6	Putting into operation
Page 7	Care of your Water Cooler
Page 8	Maintenance
Page 9	Trouble shooting





# Fontanilla

## Introduction

### Why use an Fontanilla?

The Fontanilla is designed to deliver refreshing water directly from your own mains water supply.

The Fontanilla cleans and purifies the water by removing particles, odours, colour and unpleasant tastes, and by reducing chalkiness to the same level as soft water

Water makes up 60% of your body weight, so it makes sense that the water you drink should be both pure and refreshing. With an Fontanilla from the Air and Water Centre, this is guaranteed!... on tap!

Every glass of water from an Fontanilla, passes through an active carbon filter, eliminating water sediment, Chlorine and micro organisms in the water.

Once installed, the Fontanilla is designed to operate with a minimum of maintenance, giving you a sense of confidence and peace of mind, that pure water will always be available at the touch of a tap.

### The Filtration Process

Water enters the Fontanilla through the blue manifold, before filling the filter housing cylinder and saturating the filter medium. Under mains pressure, water is passed through the filter, to provide pure water on tap.

### The Fontanilla

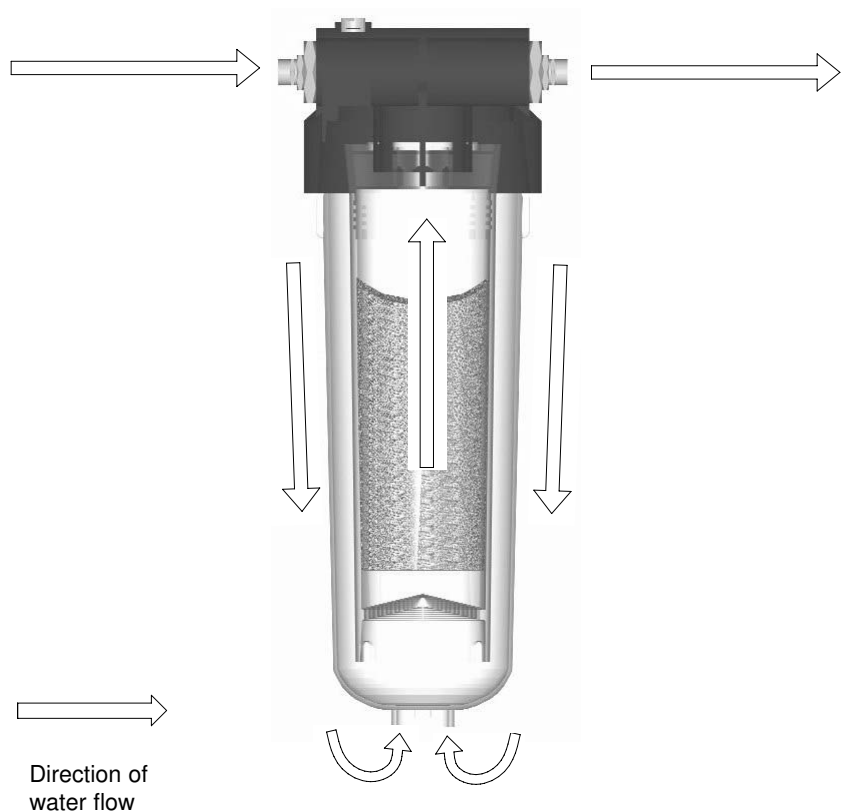



# Fontanilla Component Identification

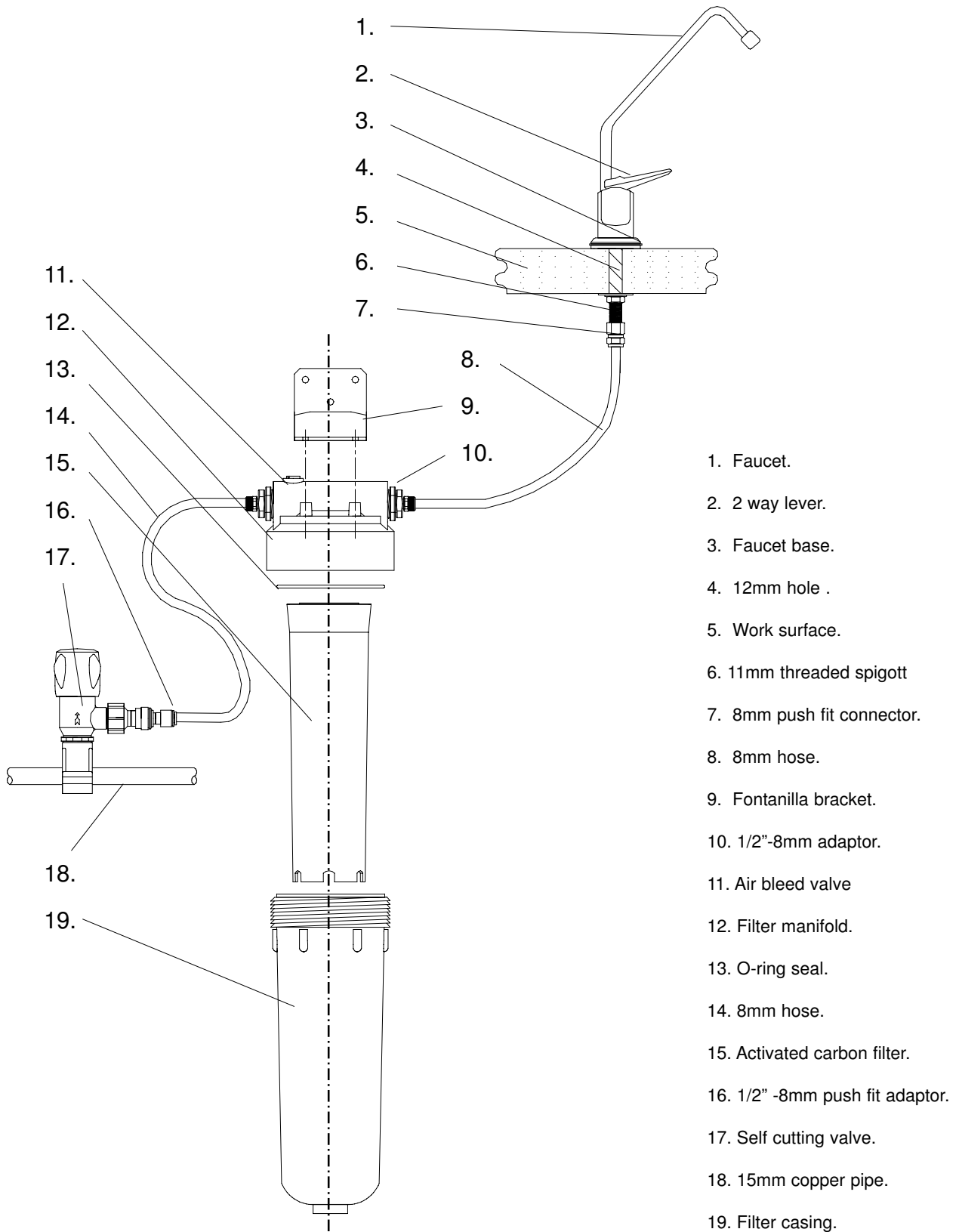



## Fontanilla Installation

### Tools for installation

Posi-drive screwdriver  
Small adjustable spanner  
Power or hand drill  
12mm drill bit  
7mm drill bit

### Installation parts

Wall mounting	-	Cream mounting bracket 2x brown expansion plug. 6x self tapping screws
Mains water	-	Self cutting valve. 1/2 inch-8mm hose adaptor 1.5m x 8mm hose
Fresh water	-	Chrome work surface fawcet Work surface attachment kit Fawcet-hose fixing kit

### Positioning

The counter tap should be positioned such that when operated, the jet of water is harmlessly run to waste via the sink

### Counter tap positioning

Positions 1 and 3 below, show the counter tap after fixing to the work surface, and overhanging the sink basin.

Position 2 below shows the counter tap after fixing to the sink. This may be necessary when the reach of the tap head is not enough to hang sufficiently over the basin when fixing to the work surface.

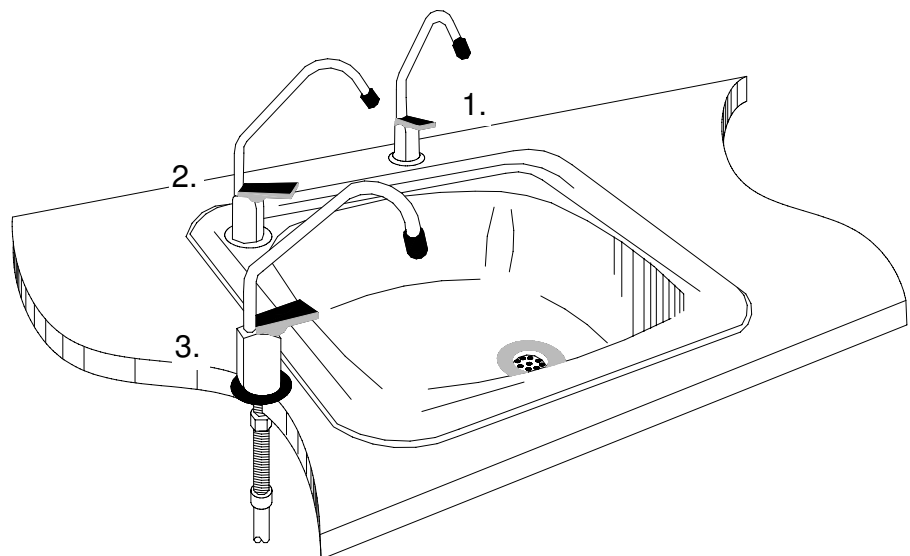



# Fontanilla Installation

## Fontanilla positioning.

When installing the Fontanilla bracket onto a surface, leave the areas indicated below clear to allow a good fit, and to allow room for pipe work and the removal of filter.

The Fontanilla should be installed directly below the counter tap, or as close as possible

Filters should not be installed in direct sunlight, and consideration should be given to the room needed for filter removal. (See diagram below.)

## Fontanilla enclosure (E.g. cupboard under sink)

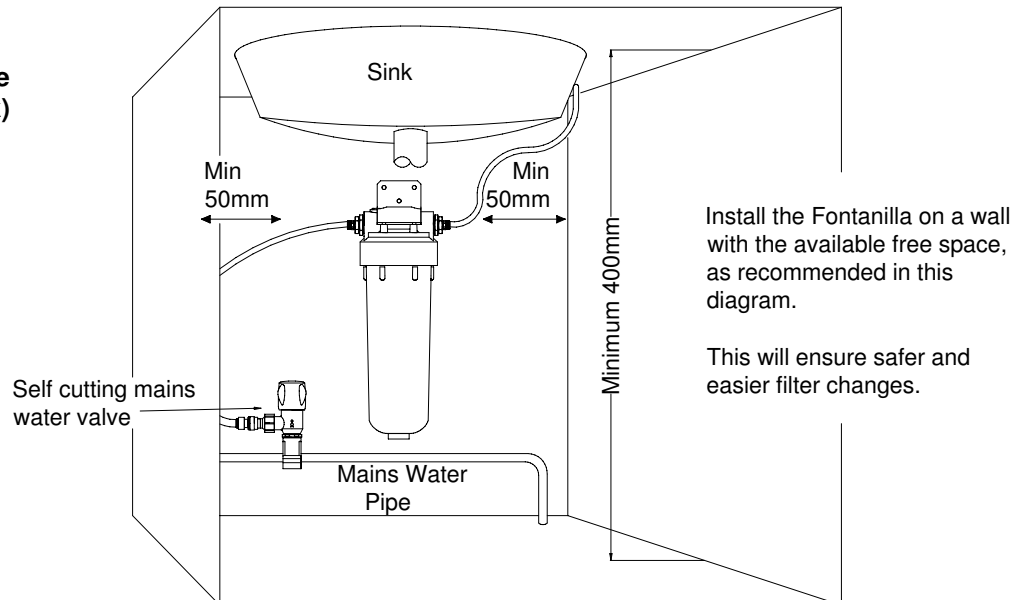

## Fontanilla bracket installation

1. Drill two 7mm holes into the wall, 45mm apart.
2. Push the two brown plugs into the wall.
3. Screw the bracket tightly onto the wall, ready for the Fontanilla



# Fontanilla Installation

## Mains Water

1. Ensure that a fresh mains water supply is located within one metre of the Fontanilla.
2. Isolate the mains water supply.
3. Push the two pipe adaptors together, and screw them onto the 1/2 inch outlet of the mains water tap provided.

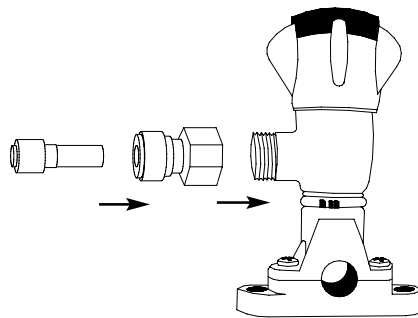

4. Cut the 8mm hose to the length required to reach the mains water pipe, and connect one end to the Fontanilla 'Water Inlet' push fit connector.

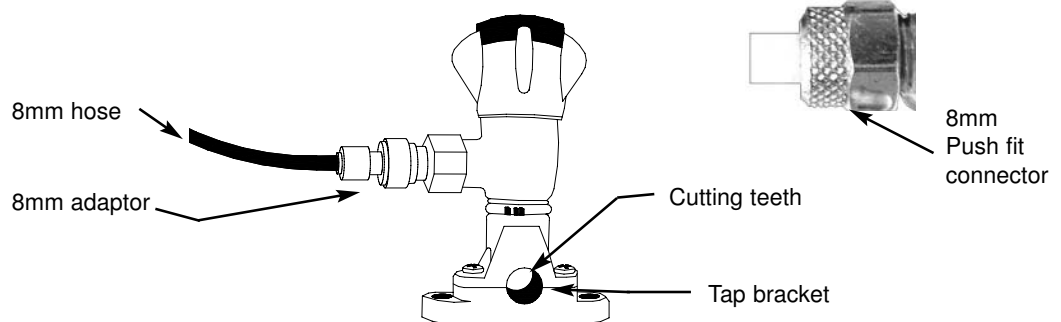

5. Unscrew the top half of the self piercing tap in an anti - clockwise direction, so that the cutting teeth withdraw into the body of the tap.
6. Clamp the tap firmly onto the pipe in the position required, using the tap bracket.
7. Turn the top half of the tap body slowly clockwise until it reaches the end of it's thread.
8. Plug the 8mm hose into the 8mm tap adaptor.  
Pull on the pipe to make sure that it is properly secured in the 8mm adaptor.
9. Do not turn on the mains water supply until the rest of the Installation procedure is complete.

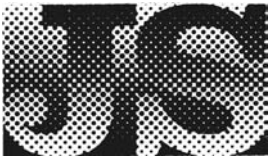

# Fontanilla Installation

- Pure water tap**
1. Drill a 12mm hole in the work surface above the Fontanilla.
  2. Put together the pure water tap assembly as shown below, and tighten the compression nuts with the small adjustable spanner.
  3. Plug one end of the 8mm hose into the right hand push fit connector of the Fontanilla, and the other end into the tap assembly shown below.

## Pure water tap assembly.

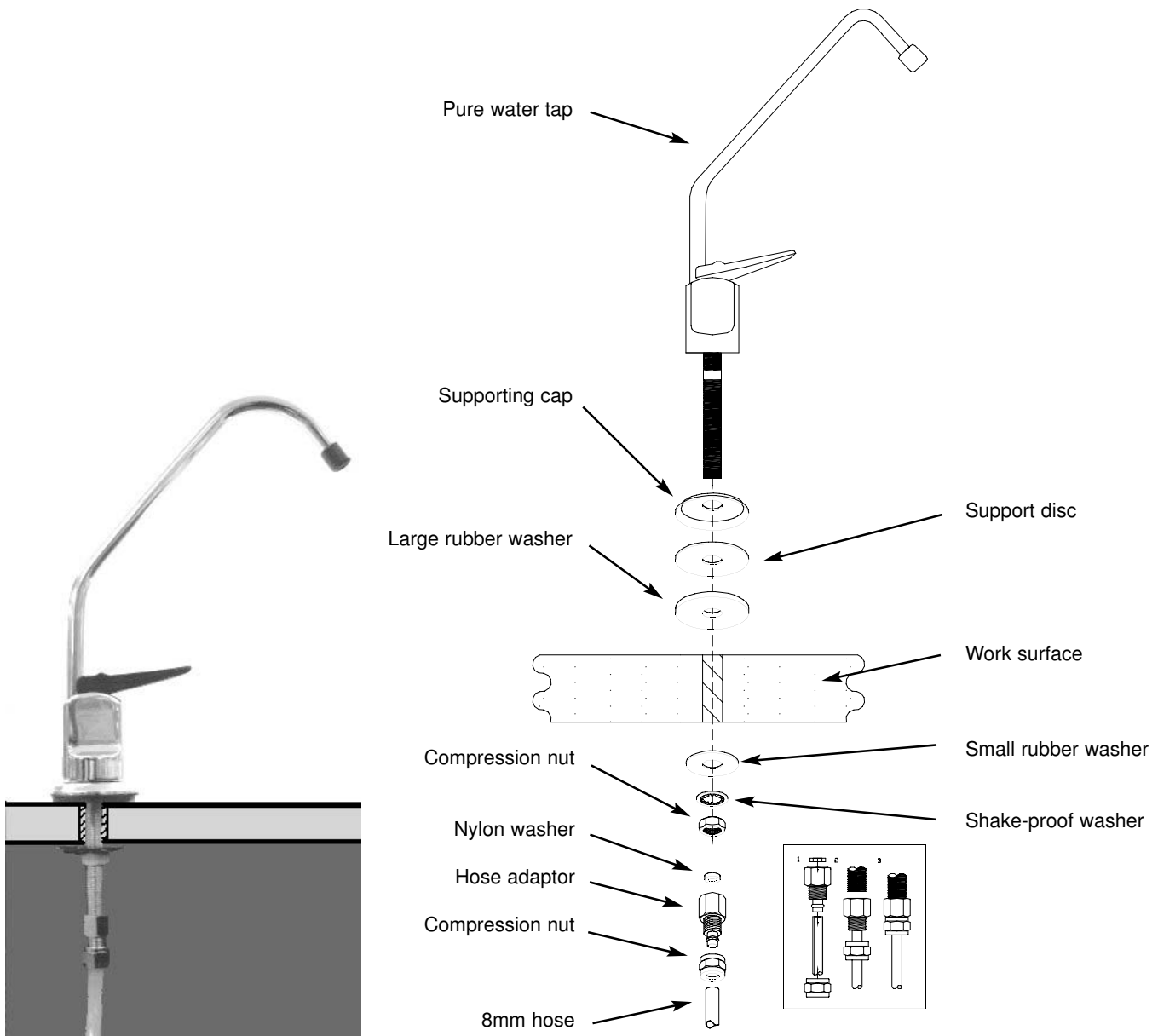

Final assembly



# Fontanilla

## Putting into operation

---

1. Check that all hose connections are tight
2. Turn on the mains water supply from the mains isolator and open the self cutting valve, by turning clockwise.
3. Allow the Fontanilla to fill up for a few minutes, then check for any leaks in the hose connections.
4. Run water from the tap for 5 minutes to purge the filter. You will find that by lifting the tap handle upwards, as shown in picture 'b', it will stick in an open position. The water may appear dirty to start off with. This is because some of the filter substrate flushes through the system.

After 5 minutes of running the water, the Fontanilla will be ready to use.

5.

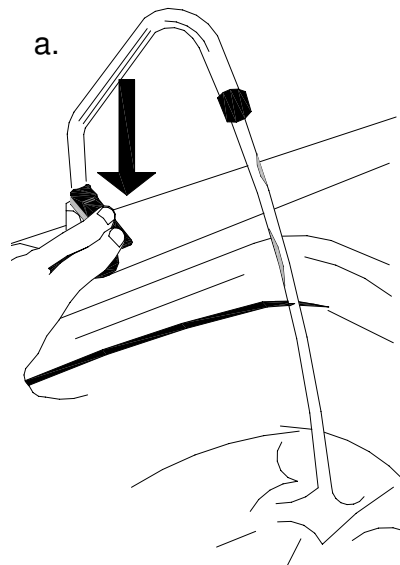

Push the handle down to fill a glass, or to run water for a few seconds.

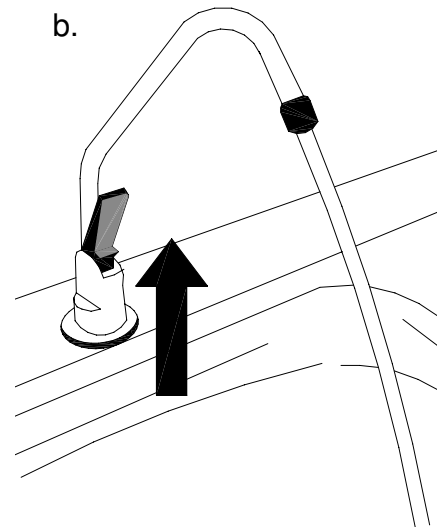

Lift the handle to run off a continual stream of water .



# Fontanilla

## Care of your Product

---

### **Product environment conditions.**

The Fontanilla is designed to run at mains water supply temperature, and should not be plumbed into the hot water supply.

Be aware of the location of your Fontanilla. If the position of the Fontanilla is close to a cooker or refrigerator, the increased temperature could affect the working efficiency.

### **After periods of non-use.**

If the Fontanilla is not used for three days or more, run the tap for at least 1 minute to clean out any water that may have stood for a while.

If you know that you are not going to be using the Fontanilla for a three or more days, turn off the Aquasana from the mains, at the self cutting valve.

### **Filter replacement.**

Replace the Activated Carbon filter every 6 months

(Follow instructions for filter replacement on the next page)

### **General hygiene.**

#### **Cleaning the filter housing.**

The filter housing will need to be cleaned out every time the cartridge is replaced or cleaned. After following the filter replacement instructions on the next page, swill out the filter housing, with mains water.

#### **Counter tap cleaning**

The pure water tap should be kept clean, to ensure the highest quality of hygienic, pure water from your Fontanilla.

Weekly cleaning of the counter tap is essential to ensure a constant supply of pure water.

There is a product available from JS that can facilitate the cleaning of the counter tap. The JS Water Cooler Spray, once sprayed onto the tap will provide fast and effective cleaning, giving you confidence that the water produced by your Fontanilla is as pure and hygienic as possible.

Just spray on, leave for 30 seconds and wipe off with a clean cloth.



Water Cooler spray for use on Fontanilla

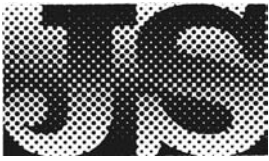

# Fontanilla Maintenance Changing filters

Turn off the water supply to your Fontanilla from the self cutting valve.

1.



Clear the working area of any items that may hamper the removal of the filter, or may be damaged by spilled water.

Line up the locating holes on the filter casing with the fontanilla spanner provided.

Firmly hold onto the filter manifold and turn the casing clockwise with the spanner.

2.



Be aware that unscrewing the casing should involve using reasonable force, as the seal between the manifold and casing will be tight.

Be ready with a bucket, to catch water tipped from the filter casing, and dripping water from the manifold.

3.



Carefully lower the filter casing away from the manifold, catching excess water in the bucket.

Dispose of the old filter, and replace with a new one. The filter sits freely in the casing, and forms a seal with the manifold when the casing is screwed into the manifold.

4.

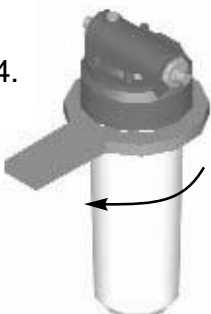

Screw the casing firmly back into the filter manifold to create a good seal.

Check that all pipework is firmly sealed, then turn on the Fontanilla from the self cutting valve.

Release the air bleed valve by turning the screw 360° in an anti-clockwise direction to clear the system of air, then turn it back again to seal the system.

Run the faucet for 5 minutes to allow the filter to work efficiently.





# Fontanilla

## Trouble-shooting

---

Symptom	Possible Fault	Action
No water, or low pressure water from counter tap	The self cutting valve tap is turned off	Turn the valve tap anti-clockwise as far as it will go
	Your mains water supply has been turned off, or is at low pressure	check the other taps in the building, then turn the mains water back on
	There is a leak in the pipe work	Follow the path of the water through the Aquasana to locate the source of the leak. Tighten all connections, or replace any split pipe work.
	The filter is blocked, incorrectly installed, or is out of date.	Check the date of purchase, with the life span of the filter. If a filter is out of date or blocked, replace it with a new one. Check the installation of the filter. There may be a blockage in the water path.
Poor water quality	See Above	See Above
	The water supply to the Fontanilla is very poor in quality.	Disconnect the Fontanilla, and do not re-connect until the water supply is of a higher quality.
Poor tasting water	One or more of your filters is blocked.	Check the replacement date of your filter, then replace any old filters. If there is a Chlorine taste in the water, replace the Active Carbon filter as soon as possible.

